



LIFTMOORE L-21W CRANE

6,000 FT.-LB. MOMENT RATING
2,000 LB. MAXIMUM CAPACITY

- Designed with the Water & Sewer Maintenance Departments in Mind.
- 62' of winch cable raises and lowers pumps out of manholes with ease.
- Boom Folds into a traveling position to take up minimum bed space.
- 2000 Lbs Capacity @ 3 ft. load radius: 850 Lbs @ 7 ft.
- Standard boom telescopes from 3' 3" to 7' 3" in two stages with an intermediate position in each stage.
- Versatility is built into this crane with it's two standard boom positions of 20 and 45 degrees.
- A hook height of 105" above mounting surface at 45 degrees and full extension.
- Rotates on tapered roller bearings for long life and easy movement.
- Full 360-degree rotation is standard.
- A manual brake band is used to control swing of the boom.
- A removable remote pendant controls the lifting function
- One man can safely handle heavy objects with this Crane.

A minimum 8,600 Lb. GVWR recommended.

OPTIONAL:
Anti-Two Block for L-21W-7

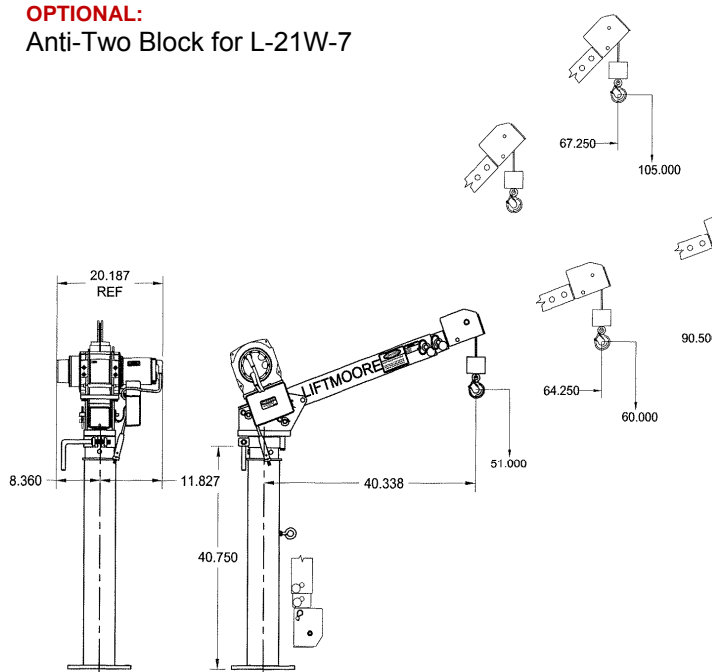

Folded height of crane is 54"



HOUSTON, TEXAS
FAX: (800) 824-5559 (USA & Canada)
FAX: (713) 688-6324
PHONE: (713) 688-5533
www.liftmoore.com

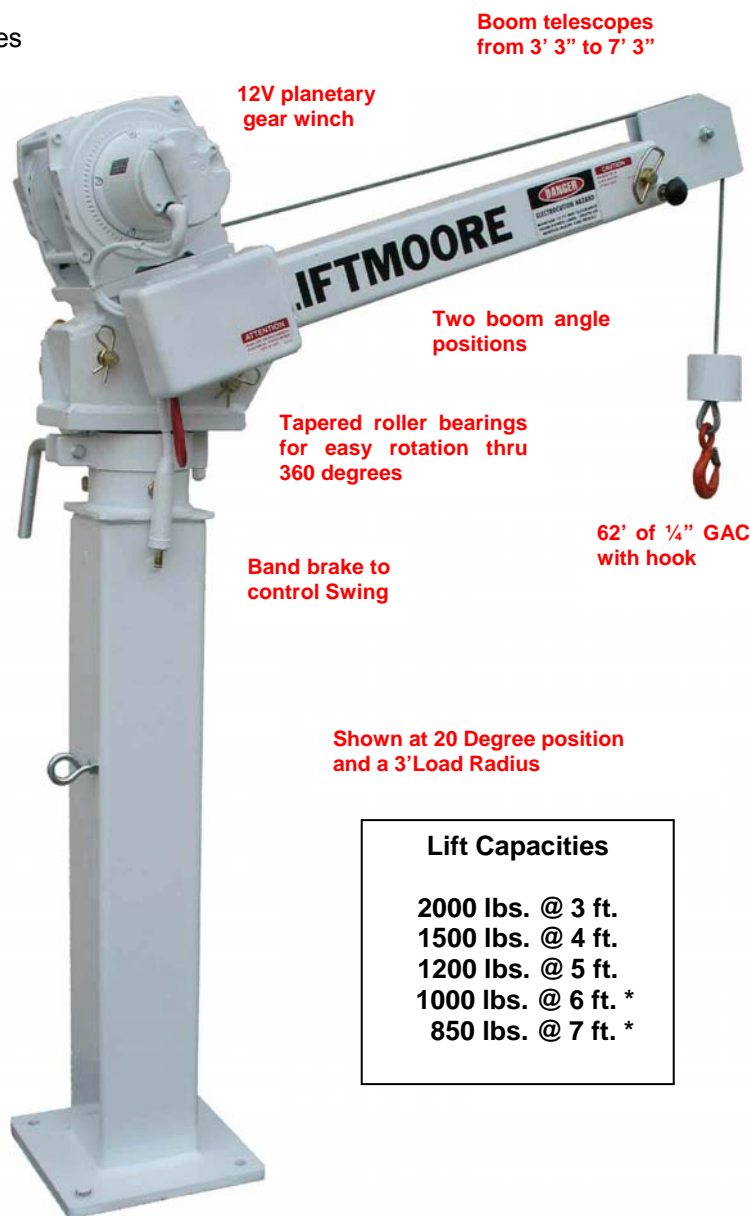

Boom telescopes
from 3' 3" to 7' 3"

12V planetary
gear winch

Two boom angle
positions

Tapered roller bearings
for easy rotation thru
360 degrees

Band brake to
control Swing

62' of 1/4" GAC
with hook

Shown at 20 Degree position
and a 3' Load Radius

Lift Capacities

2000 lbs. @ 3 ft.
1500 lbs. @ 4 ft.
1200 lbs. @ 5 ft.
1000 lbs. @ 6 ft. *
850 lbs. @ 7 ft. *

Winch:

Planetary gear drive
With permanent magnet 2.7 HP Motor

Performance		
Load (Pounds)	Hook Speed (Feet per Minute)	Electrical (Amperes)
1000	13.1	64
2000	11.9	115



Back Page is Left Blank



HOUSTON, TEXAS
FAX: (800) 824-5559 (USA & Canada)
FAX: (713) 688-6324
PHONE: (713) 688-5533
www.liftmoore.com